

# HOMESCOR

PREFABRICATED BUILDINGS SINCE 1985

[www.homescor.com](http://www.homescor.com)

Tel : 011 363-0599

Fax : 011 363-3386

Cell : 072 070 0898

P O Box 12114

SEL COURT

1567

## PLAN B TWO BEDROOMED FLATLET 3,6 X 10,8M (42,0M<sup>2</sup>)

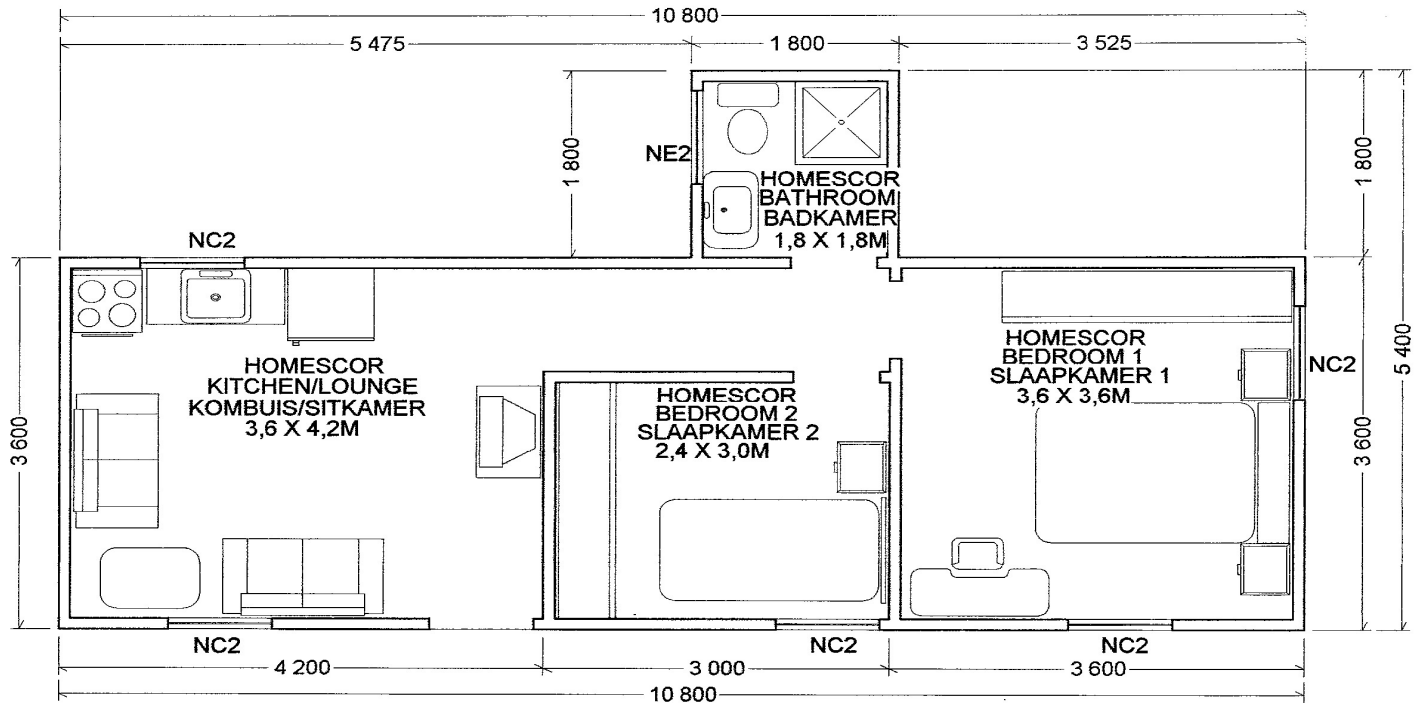

### **SINGLE WALL PANEL UNIT – not insulated between walls**

**TOTAL – INCLUDING VAT R89 840.00**

Installation as per plan, concrete floor, insulated ceilings and walls painted inside and outside with acrylic PVA.

Single fibre cement wall panels, sturdy steel frame, steel window frames, meranti outside door with steel door frame, fibre cement inside doors and IBR pitched roof, (not painted).

### **DOUBLE WALL PANEL UNIT – insulated between walls**

**TOTAL – INCLUDING VAT R149 250.00**

Installation as per plan, concrete floor, insulated ceilings and walls painted inside and outside with acrylic PVA, doors and window frames painted with enamel.

Fibre cement wall panels outside, dry walling panels inside with insulation, concealed sturdy steel frame, steel window frames, meranti outside door with steel frame, masonite doors with steel frames inside and IBR pitched roof, (not painted).

**DELIVERY NOT INCLUDED R10.00 PER KM - ONE WAY FROM BOKSBURG**

### **SANITARY WARE (not included):**

**R 4 700.00**

1 x Toilet, 1 x hand basin with taps, 1 x shower

(shower floor with drain pipe, taps and shower rose – no curtain or shower door)

Supplied and fitted only – not connected to water and sewerage

### **ELECTRICAL FITTINGS (not included) :**

**R 8 342.00**

4 x Bowl lights with switches and 6 x single plugs.

Supplied and fitted only – not wired and connected.