

# HOMESCOR

PREFABRICATED BUILDINGS SINCE 1985

www.homescor.com

TEL : 011 918-7557  
FAX : 011 918-7558  
CELL : 072 070 0898

P O Box 7252  
WESTWOOD  
1477

## PLAN A ONE BEDROOMED FLATLET 3,6 x 9,6M (34,56M<sup>2</sup>)

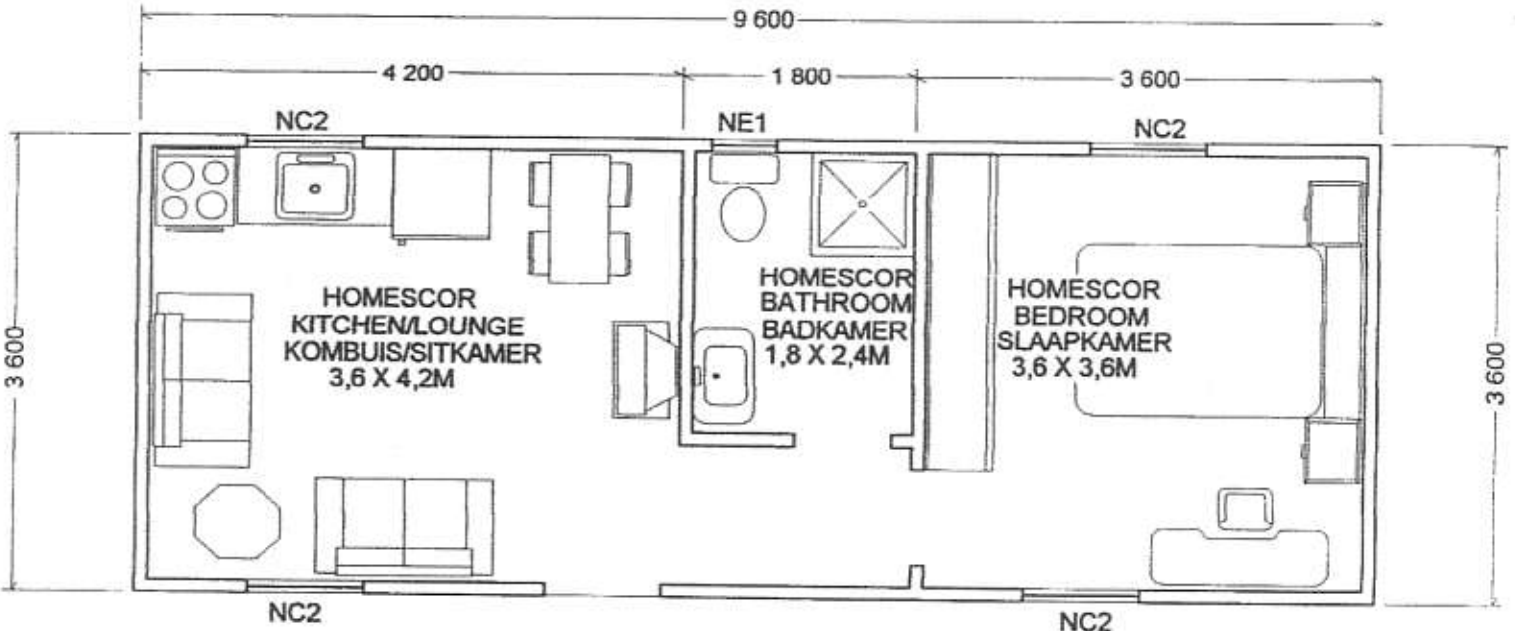

### **SINGLE WALL PANEL UNIT**

**TOTAL – INCLUDING VAT R60,150.00**

Installation as per plan, concrete floor, insulated ceilings and walls painted inside and outside with acrylic PVA.

Single fibre cement wall panels, sturdy steel frame, steel window frames, meranti outside door with steel door frame, fibre cement inside doors and IBR pitched roof, (not painted).

### **DOUBLE WALL PANEL UNIT – insulated between walls**

**TOTAL – INCLUDING V A T R100,950.00**

Installation as per plan, concrete floor, insulated ceilings and walls painted inside and outside with acrylic PVA, doors and window frames painted with enamel.

Fibre cement wall panels outside, dry walling panels inside with insulation, sturdy concealed steel frame, steel window frames, Meranti outside door with steel door frame, masonite doors with steel door frames inside and IBR pitched roof. (Roof not painted).

### **DELIVERY NOT INCLUDED – R8,00KM ONE WAY FROM BOKSBURG**

#### **SANITARY WARE (not included):**

**R 3,970.00**

1 x Toilet, washbasin with taps, shower (shower floor with drain pipe, taps and shower rose – no curtain or shower door);  
(Supplied and fitted only – not connected).

#### **ELECTRICAL FITTINGS (not included) :**

**R 3,860.00**

3 x Bowl lights with light switches and 4 x single plugs  
(Supplied and fitted only – not wired and connected).